

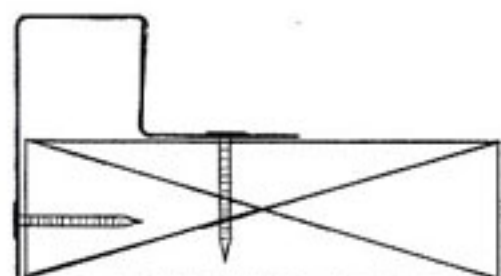

CASTLE METAL PRODUCTS

Z-LOC INSTALLATION GUIDE



STEP 1

NAIL A CONTINUOUS GALVANIZED CANT DAM TO AN APPROVED NAILER BY USING A 1 1/4 GALVANIZED NAIL. NAILS SHOULD BE 12" ON CENTER AND THERE SHOULD BE A 3/16 GAP BETWEEN THE CANT DAM FOR EXPANSION.

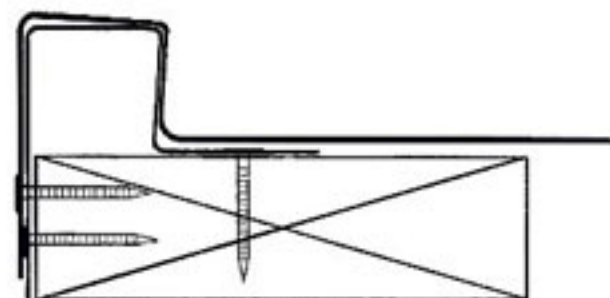

STEP 2

LAY ROOFING MEMBRANE OVER THE CANT DAM SO THAT THE MEMBRANE IS AT LEAST 3" OVER FACE OF THE CANT DAM

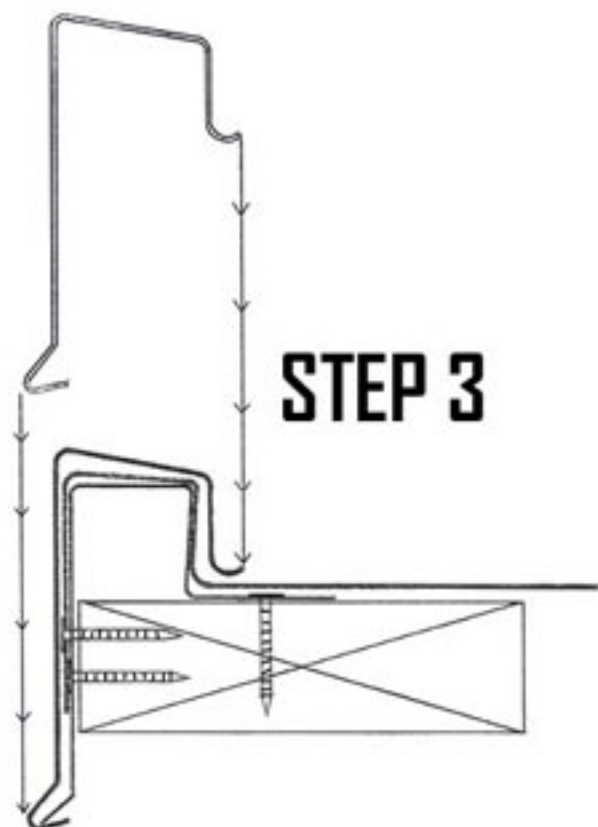

STEP 3

SNAP FASCIA SECTION DOWN IN PLACE MAKING SURE THE DRIP EDGE ENGAGES THE CANT DAM. YOU MUST ALSO APPLY THE SPLICE PLATE AT THIS POINT. LEAVE AT LEAST 1/4 GAP FOR EXPANSION.

Castle Metal Products
906 Estes Court
Schaumburg, IL 60193
Phone: 1-847-806-4540
Fax: 1-847-806-4541
E-Mail castlemetal@msn.com